

COMMERCIAL DURABILITY NOW AVAILABLE FOR YOUR HOME



ADEE9RW & ADGE9RW
ELECTRIC GAS

1027

689

BUILT TO LAST

We still make them like we used to. Built to last up to 25 years in the home - 10,400 cycles.

DURABLE

Three-coat, commercial-grade steel cabinet will look good and last for years to come.

EXTRA CAPACITY

Large 198 litre capacity cylinder with the largest door opening means it can handle the biggest loads, so you spend less time in the laundry.

FABRIC CARE

Whisper quiet, superior airflow of 85 litres per second results in faster drying with less wear, and less wrinkling of clothes.

ENERGY EFFICIENT

Four temperature setting options and auto dry feature ensure the dryer does not over dry items wasting valuable time, energy and money.

AVERAGE CYCLE TIMES

Full load in 45-50min.

ADEE9RWS433AW01 ELECTRIC & ADGE9RWS303AW01 GAS

TOUCH DRYER

THIS DRYER MATCHES THE AWNE92 TOP LOAD WASHER

MODEL NUMBERS	ADEE9RWS433AW01 (Electric) ADGE9RWS303AW01 (Gas)	TEMPERATURE SETTINGS	4
CAPACITY	8.2 kg IEC	SHOE DRYER RACK	Optional (part number 512082)
QUIET, EFFICIENT BLOWER	Yes	CABINET	Galvanised Steel
DIMENSIONS (H X W X D)	1092 x 683 x 711 mm	CYLINDER FINISH	White
DRYER DRUM CAPACITY (LITRES)	198 L	CYCLE INDICATOR LIGHT	Yes
DRYER DOOR WIDTH	525 mm	END-OF-CYCLE BUZZER	Yes
DRYER DOOR HINGE	Reversible	AUTOMATIC DRY CYCLES	Yes
DRYER MOTOR HORSEPOWER	1/3 hp	TIME DRYING	Yes
AVAILABLE HEAT SOURCES	Electric or Gas (NG or LP)	GAS INLET CONNECTION	3/8 NPT
ELECTRICAL REQUIREMENTS (VOLTAGE/HZ/PH)	240V / 50 Hz AC / 1 Ph	HEATING ELEMENT	4000 W (Electric)
DRYER BREAKER SIZE	20 (Electric) 10 (Gas) Amps	MULTIPLE VENT OPTIONS	Yes
GAS CONSUMPTION MJ	21.1 MJ (Gas)	EXHAUST VENT SIZE	102 mm
AVAILABLE CYCLES	Heavy Duty, Regular, Perm Press, Delicate, Time Dry, Quick Dry, Fluff Up & Favourite cycle	AUSTRALIAN GAS APPROVAL	Yes
		LP CONVERSION KIT	Optional
		SHIPPING DIMENSIONS (H X W X D)	1156 x 737 x 832 mm
		SHIPPING WEIGHT	Electric - 64 kg Gas - 66 kg

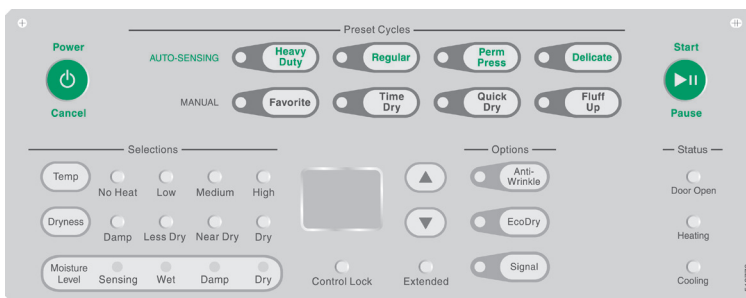

Image, price and information are subject to change without notice.

SPEED QUEEN DRYER SUPREMACY